

The battle for the human heart

Acts 4:1-22



Earthrise - photo taken by Astronaut Bill Anders on Apollo 8

https://www.nasa.gov/sites/default/files/images/297755main_GPN-2001-000009_full.jpg



Earth

<https://www.desiringgod.org/articles/god-put-you-on-the-pale-blue-dot>



Earth - our "pale blue dot," photographed from Voyager 1 in 1990, from a distance of 3.7 billion miles
<https://upload.wikimedia.org/wikipedia/commons/7/71/PaleBlueDot.jpg>



- 1 The **Gate of the Essenes** allowed the Essenes to access latrines outside the city walls in accordance with their strict laws of hygiene.
- 2 **Herod's Palace** was the Jerusalem home of Herod the Great from 23 to 4 b.c. Pilate, who normally resided in Caesarea Maritima, resided in this palace during his visits to Jerusalem, including his visit for the Passover preceding Christ's crucifixion.
- 3 The **Praetorium** was in Herod's Palace (Matt. 27:27; Mark 15:16), which served as Pilate's official headquarters and as a fortress. A raised stone pavement, used for official judgments, stood outside the palace and was the site of Jesus' condemnation under Pilate (John 19:13).
- 4 Herod the Great fortified three towers to protect his palace: from west to east there was the **Tower of Hippicus** (155 feet/47 m tall), the **Tower of Phasael** (138 feet/42 m tall), and the **Tower of Mariamme** (95 feet/29 m tall).
- 7 The two-level **Palatial Mansion** (6,500 sq. feet/604 sq. m) may have been the Palace of Annas, who served as high priest from A.D. 6 to 15. Annas's son-in-law Caiaphas held this office from A.D. 18 to 36 and presided at the trial of Jesus (Matt. 26:57).

- 5 This is often considered the most likely location of **Golgotha**, the place of Jesus' death. It was on a hill overlooking a quarry, outside the Second Wall of the city and near the Gennath (Garden) Gate.
- 8 Herod the Great lived in the luxurious **Hasmonean Palace** from the mid-30s to 23 b.c. while awaiting the building of his own new palace. Herod Antipas ("Herod the Tetrarch") lived in this palace during his reign, 4 b.c.–A.D. 39. Jesus appeared before him here in either A.D. 30 or 33.
- 10 The **Archives** building contained the public registers (including genealogies) as well as bonds taken by moneylenders, which allowed the recovery of debts.
- 11 The **Xystus**, built on the site of the former Greek Gymnasium, was a place of mass assembly.

- 12 The **Council House** was a public building, used perhaps as a municipal office.
- 13 **The Temple** was reconstructed by Herod the Great, beginning in 20/19 b.c.
- 14 The **Bethesda Pools** (see John 5:2) were twin pools, each measuring c. 312 by 164–196 feet (95 by 50–60 m), and c. 50 feet (15 m) deep. A small Roman temple dedicated to Aesculapius stood to the east of the pools.

- 15 The **Garden of Gethsemane** was located approximately 300 yards (274 m) from Jerusalem and the Temple Mount. The Mount of Olives was "a Sabbath day's journey away" from Jerusalem (Acts 1:12), approximately 1,100 yards, or 3/5 of a mile.
- 16 The ravine of the **Kidron Valley** has always served as Jerusalem's eastern boundary.
- 17 The **Pool of Siloam** (cf. John 9:7), a focal point of Jerusalem, adjoined a large dam and reservoir, and received water from the Gihon Spring.
- 18 The **Hinnom Valley** was to the south of the hill that was the original city of David.
- 19 The **Upper City** housed luxurious villas of wealthy residents in the Herodian period.

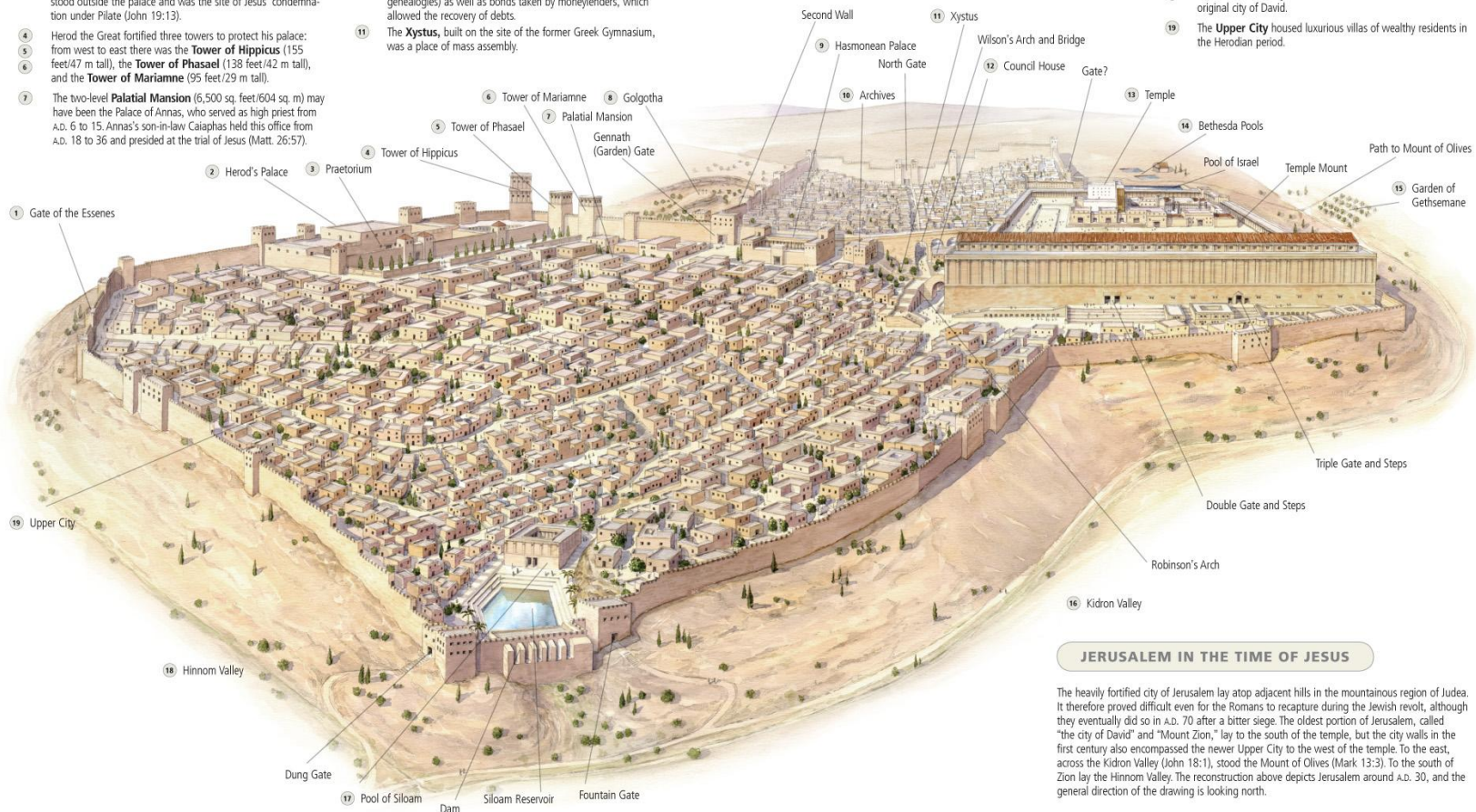

JERUSALEM IN THE TIME OF JESUS

The heavily fortified city of Jerusalem lay atop adjacent hills in the mountainous region of Judea. It therefore proved difficult even for the Romans to recapture during the Jewish revolt, although they eventually did so in A.D. 70 after a bitter siege. The oldest portion of Jerusalem, called "the city of David" and "Mount Zion," lay to the south of the temple, but the city walls in the first century also encompassed the newer Upper City to the west of the temple. To the east, across the Kidron Valley (John 18:1), stood the Mount of Olives (Mark 13:3). To the south of Zion lay the Hinnom Valley. The reconstruction above depicts Jerusalem around A.D. 30, and the general direction of the drawing is looking north.

THE TEMPLE MOUNT IN THE TIME OF JESUS

Herod's Temple Mount was the focal point of Jerusalem during the time of Jesus. Sitting atop Jerusalem's north-eastern ridge, it occupied one-sixth of the city's area. Under Herod the Great, the Temple Mount's foundation was expanded to encompass approximately 1.5 million square feet (140,000 square meters). Its foundational walls were constructed using gigantic stones, the largest found being 45 feet long, 11.5 feet high, and 12 feet thick (13.7 m by 3.5 m by 3.7 m).

Wilson's Arch formed a bridge over the Tyropoeon Valley below, leading from the Temple Mount to the Hasmonean Palace. A section of the western wall south of Wilson's Arch (187 feet/57 m long, sometimes called the Walling Wall) has been a place of prayer for Jews for the last 700 years. The lowest seven stone courses, which can be seen at ground level, are Herodian.

The early square Temple Mount preserved its identity as a separate area with its own walls and gates.

Robinson's Arch and its massive stairway led from the Tyropoeon Street below up to the Royal Stoa.

The Double Gate and its monumental stairway

A ritual bath-house for pilgrims to cleanse before entering the temple precincts

A Council House for legal proceedings

The Triple Gate and its stairway

Small shops, which had a narrow street built above them, were built along the southern wall of the Temple Mount.

The Antonia Fortress was where Herod (and later the Romans) commanded the garrison in order to protect the temple and to suppress religiously motivated rebellion.

Herod's Temple (for a detailed cutaway drawing, see p. 1943)

The Court of the Women was the farthest point of the inner temple complex that women could enter.

The Pool of Israel was probably used to wash sacrificial animals before they were led to the Temple Mount.

The Golden Gate, then known as the Shushan Gate

Stairs descended from the Muster Gate into the Kidron Valley and eventually went up to the Mount of Olives.

The eastern city wall of Jerusalem

Solomon's Porch, the portico built along the eastern wall, was a place of congregation (cf. John 10:23; Acts 3:11).

The sores (a low, latticed screen or railing) prohibited Gentiles or non-purified Jews from entering the temple courts.

The Court of the Gentiles was the area between the sores and the outer walls of the early square Temple Mount.

The Royal Stoa was a 912-foot-long (278 m) portico, containing four rows of 40 columns. The Sanhedrin met in the central apse after c. A.D. 30. This may have been where Jesus cleansed the temple. The southeast corner overlooking the Kidron Valley created a drop of 140 feet (43 m) to the street below, and 300 feet (91 m) to the valley below. This may be the "pinnacle of the temple" mentioned in Matt. 4:5 and Luke 4:9.

Temple Mount Architectural Plan

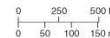
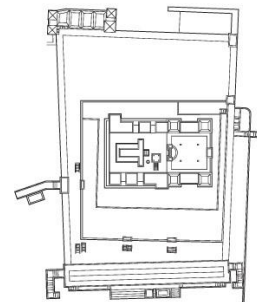



Solomon's Portico? - scale model at the Holy Land Hotel
<https://readingacts.com/2015/01/30/acts-512-solomons-portico>



Solomon's Portico? - Second Temple Model of Jerusalem

https://www.bible-history.com/jerusalem/firstcenturyjerusalem_royal_porticoes.html



Solomon's Portico - artist's rendition

<http://bibleillustration.blogspot.com/2010/09/bible-artist-news.html>

THE TEMPLE MOUNT IN THE TIME OF JESUS

Herod's Temple Mount was the focal point of Jerusalem during the time of Jesus. Sitting atop Jerusalem's north-eastern ridge, it occupied one-sixth of the city's area. Under Herod the Great, the Temple Mount's foundation was expanded to encompass approximately 1.5 million square feet (140,000 square meters). Its foundational walls were constructed using gigantic stones, the largest found being 45 feet long, 11.5 feet high, and 12 feet thick (13.7 m by 3.5 m by 3.7 m).

Wilson's Arch formed a bridge over the Tyropocon Valley below, leading from the Temple Mount to the Hasmonean Palace. A section of the western wall south of Wilson's Arch (187 feet/57 m long, sometimes called the Walling Wall) has been a place of prayer for Jews for the last 700 years. The lowest seven stone courses, which can be seen at ground level, are Herodian.

The early square Temple Mount preserved its identity as a separate area with its own walls and gates.

Robinson's Arch and its massive stairway led from the Tyropocon Street below up to the Royal Stoa.

The Double Gate and its monumental stairway

A ritual bath-house for pilgrims to cleanse before entering the temple precincts

A Council House for legal proceedings

The Triple Gate and its stairway

Small shops, which had a narrow street built above them, were built along the southern wall of the Temple Mount.

The Antonia Fortress was where Herod (and later the Romans) commanded the garrison in order to protect the temple and to suppress religiously motivated rebellion.

Herod's Temple (for a detailed cutaway drawing, see p. 1943)

The Court of the Women was the farthest point of the inner temple complex that women could enter.

The Pool of Israel was probably used to wash sacrificial animals before they were led to the Temple Mount.

The Golden Gate, then known as the Shushan Gate

Stairs descended from the Muster Gate into the Kidron Valley and eventually went up to the Mount of Olives.

The eastern city wall of Jerusalem

Solomon's Porch, the portico built along the eastern wall, was a place of congregation (cf. John 10:23; Acts 3:11).

The soreg (a low, latticed screen or railing) prohibited Gentiles or non-purified Jews from entering the temple courts.

The Court of the Gentiles was the area between the soreg and the outer walls of the early square Temple Mount.

The Royal Stoa was a 912-foot-long (278 m) portico, containing four rows of 40 columns. The Sanhedrin met in the central apse after c. A.D. 30. This may have been where Jesus cleansed the temple. The southeast corner overlooking the Kidron Valley created a drop of 140 feet (43 m) to the street below, and 300 feet (91 m) to the valley below. This may be the "pinnacle of the temple" mentioned in Matt. 4:5 and Luke 4:9.

Temple Mount Architectural Plan

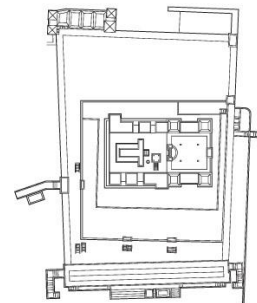

0 50 100 150 m
0 50 100 150 ft

...ed to encompass approximately 1.5 million square feet (140,000 square meters). Its foundational... constructed using gigantic stones, the largest found being 45 feet long, 11.5 feet high, and 12 feet... m by 3.5 m by 3.7 m).

Wilson's Arch formed a bridge over the Tyropoeon Valley below, leading from the Temple Mount to the Hasmonean Palace. A section of the western wall south of Wilson's Arch (187 feet/57 m long, sometimes called the Wailing Wall) has been a place of prayer for Jews for the last 700 years. The lowest seven stone courses, which can be seen at ground level, are Herodian.

The early square Temple Mount preserved its identity as a separate area with its own walls and gates.

Herod's Temple cutaway drawing

Wilson's Arch and its massive... from the Tyropoeon... up to the Royal Stoa.

The Double Gate and its... monumental stairway

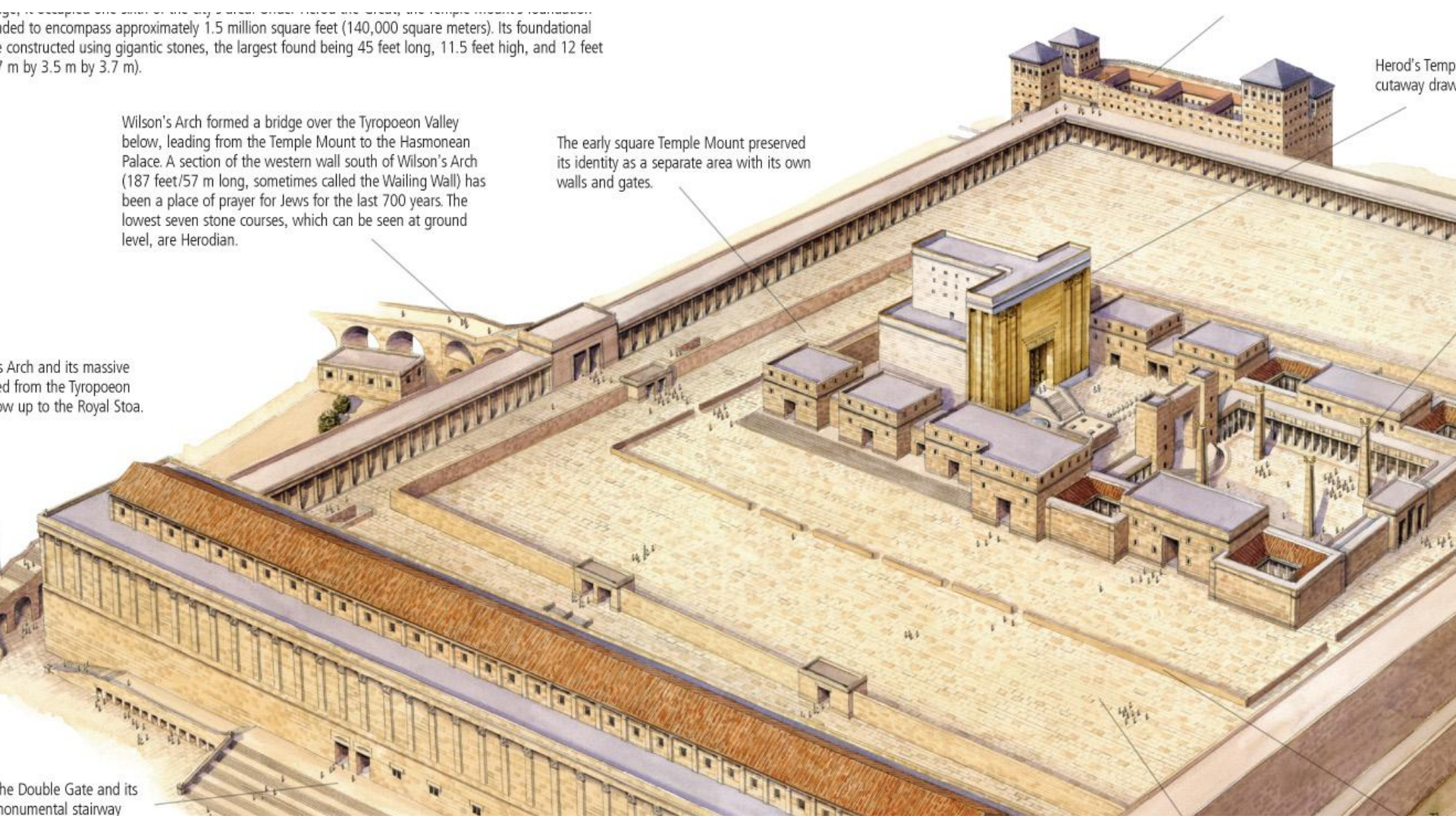

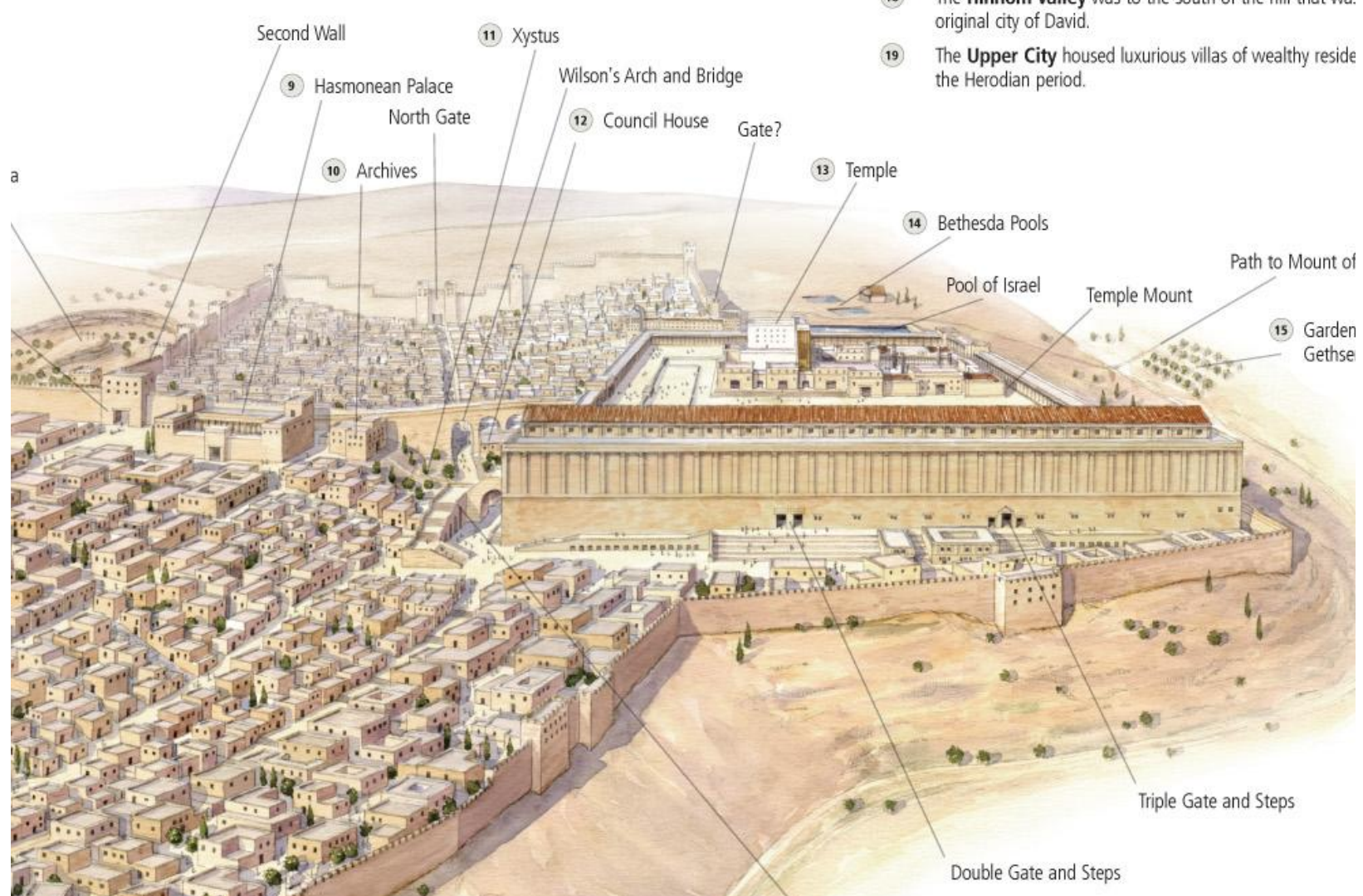

the **Timnon Valley** was to the south of the hill that was the original city of David.

19 The **Upper City** housed luxurious villas of wealthy residents during the Herodian period.

Second Wall

11 Xystus

19

original city of David.
The **Upper City** housed
the Herodian period.

9 Hasmonean Palace

Wilson's Arch and Bridge

North Gate

12 Council House

Gate?

10 Archives

13 Temple

14 Bethesda Pools

Pool of Israel

Ten

